

ELEV Box8

User Manual

1.0mL/2.0mL Disposable



Specifications

| | |
|------------------|---------------------------------------|
| Dimension(mm) | 65.3H*40.5W*17.1D |
| Tank Material | Food Grade PCTG |
| Central Post | Medical Grade SUS316L Stainless Steel |
| Battery Housing | PC |
| Output Power | 9.25W |
| Resistance | 1.25Ω |
| Battery Capacity | 280mAh |
| Charging | USB Type-C |
| Activation | Inhale Activated |
| Tip Type | Snap In |



Filling Instruction

CILICON⁺

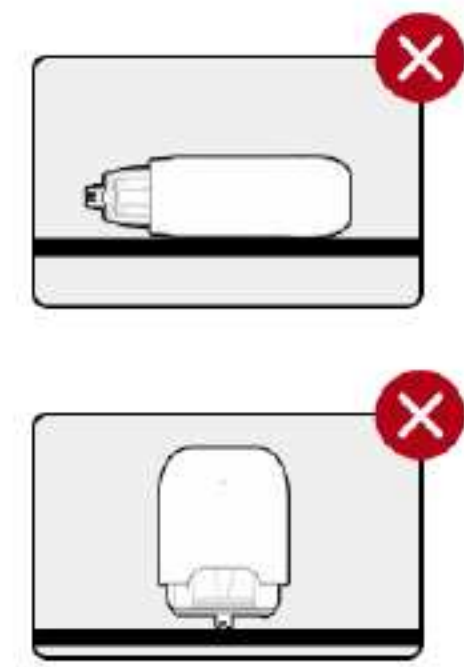

1

- Unpackge the cartridge and make sure it is vertically upright with the tray.

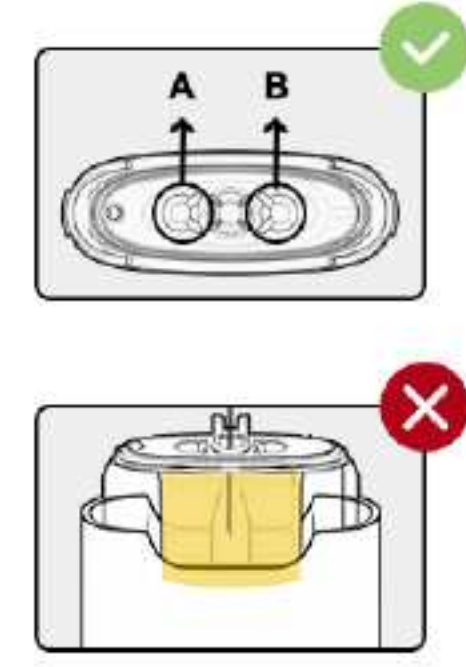

2

- Do not unplug the silicone cap when filling the oil.
- Insert the needle appropriately into the filling space, and do not insert it into the central tube.
- Make sure the needle diameter is $\leq 1.8\text{mm}$.

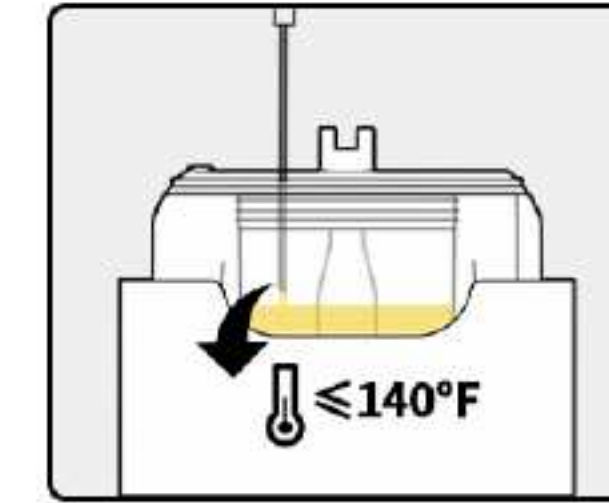
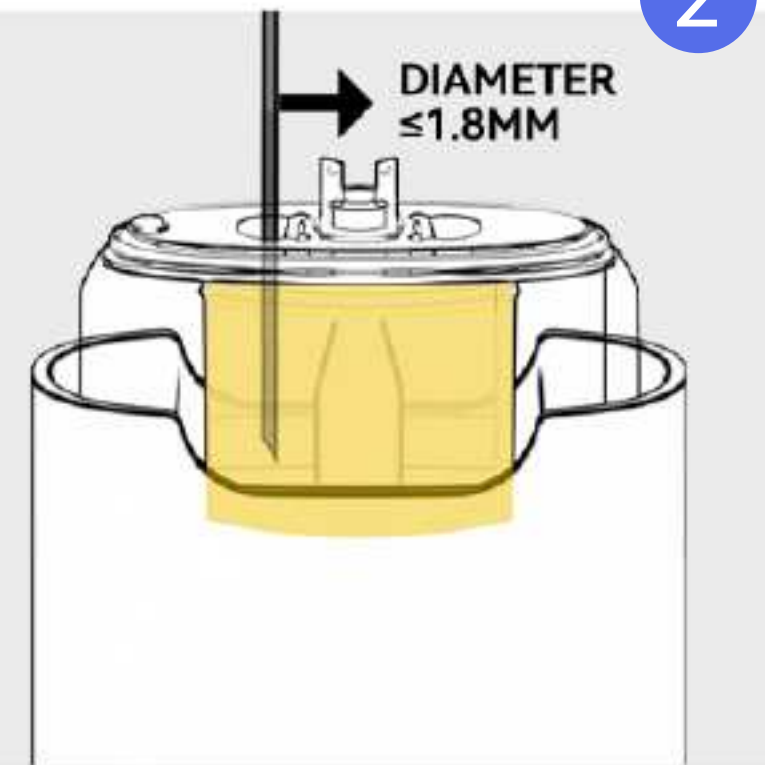

3

- The output temperature must be under 140°F.

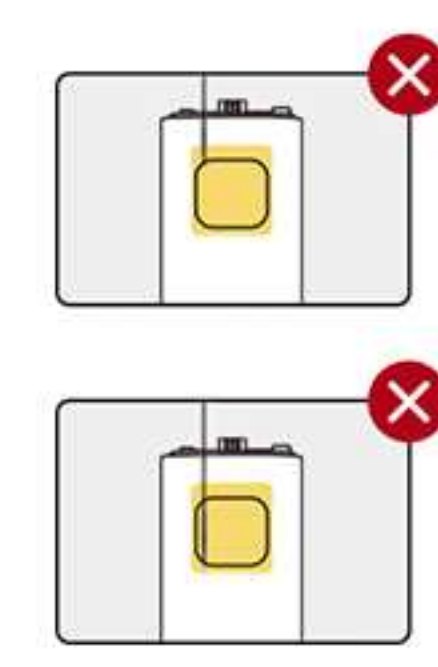

4

- The length of the needle is 2/3 of the height of the oil tank.
- Avoid the needle touching the bottom of the oil tank
- Fill in 0.95-1.0mL/1.95-2.0mL for a 1mL/2mL device.

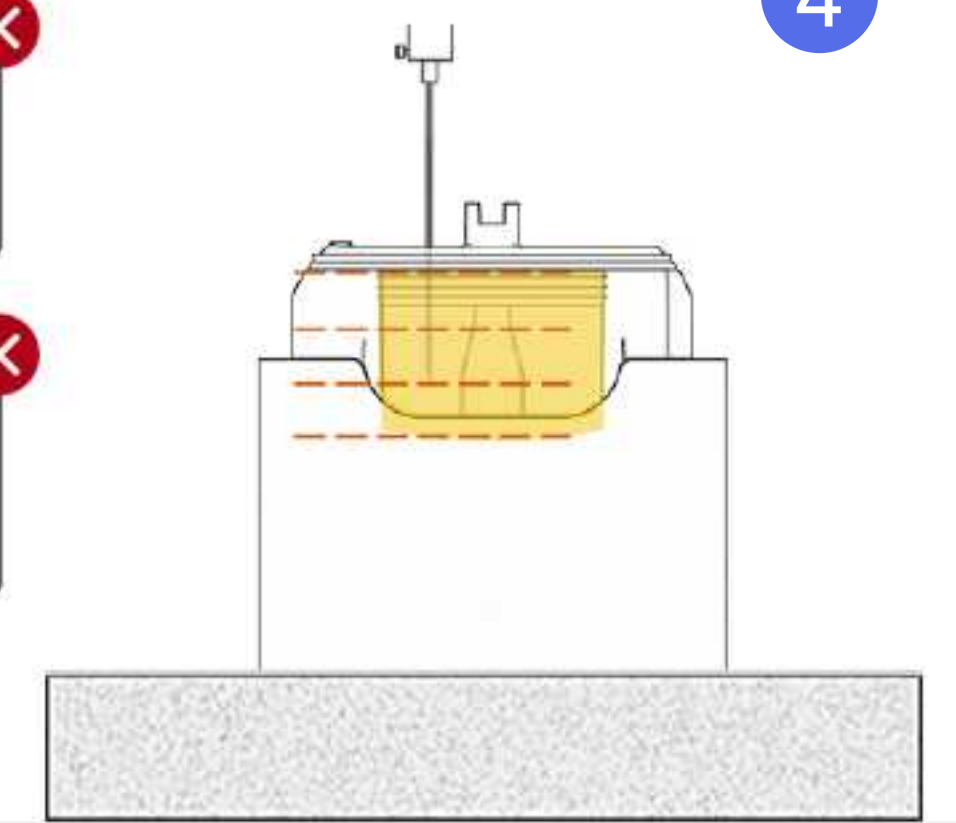

5

- When snapping in the mouthpiece, it should be vertical to the device and forced evenly.

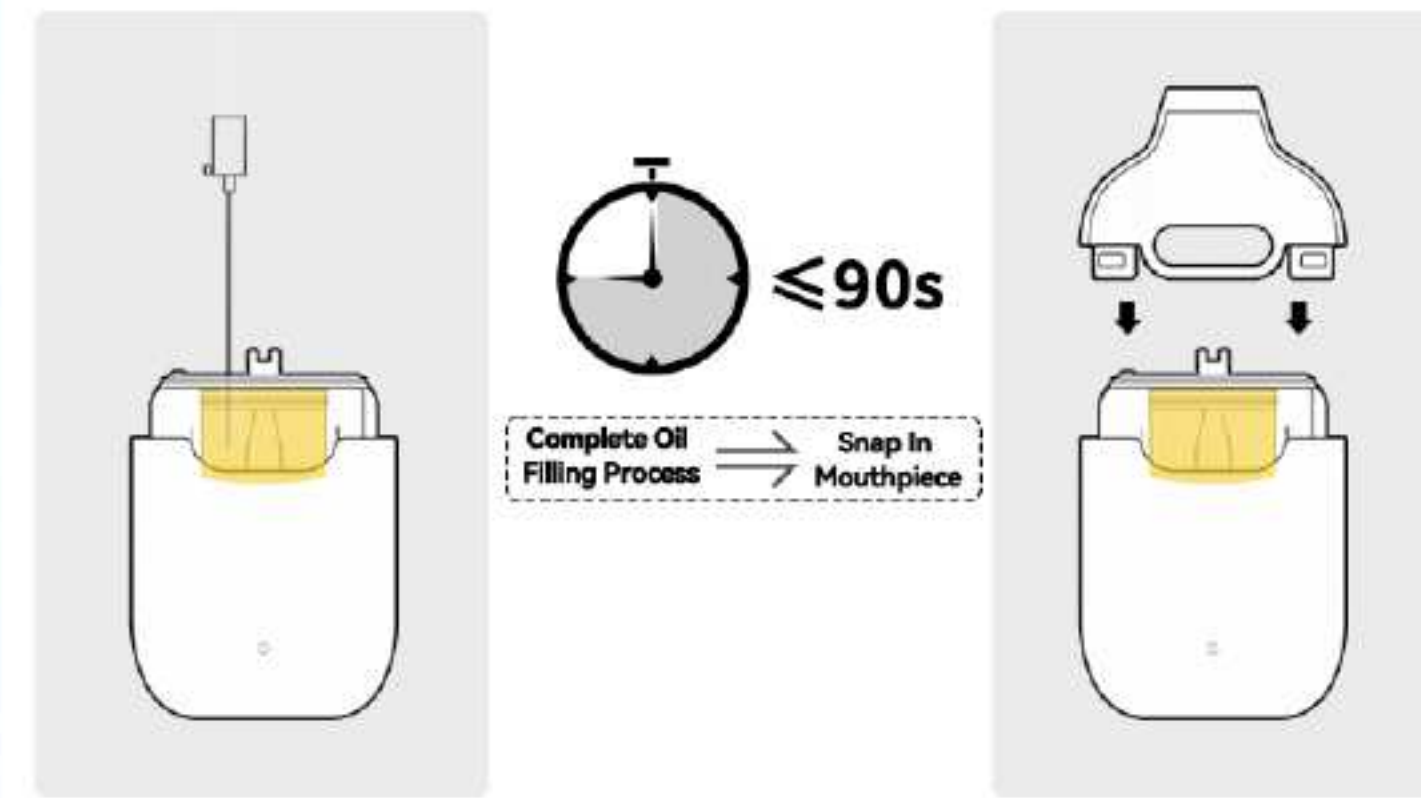
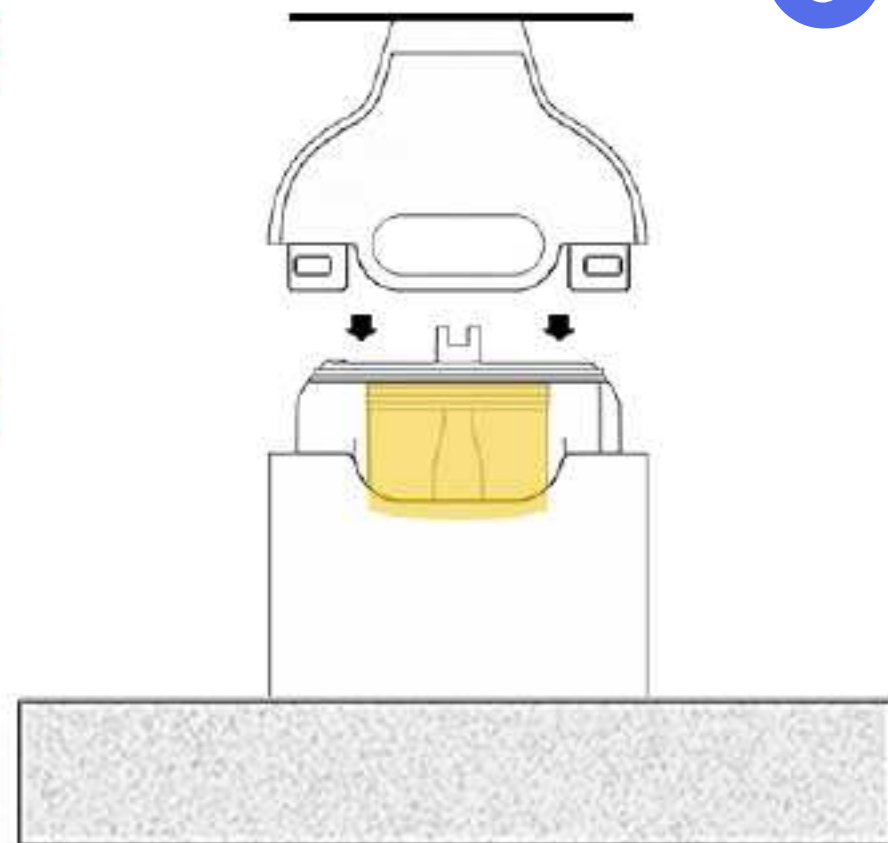

6

- Complete the snapping process within 90s after filling the oil.



7

- Ensure the silicone cap is on the mouthpiece after completing the filling process.
- Wait 4 hours before use.

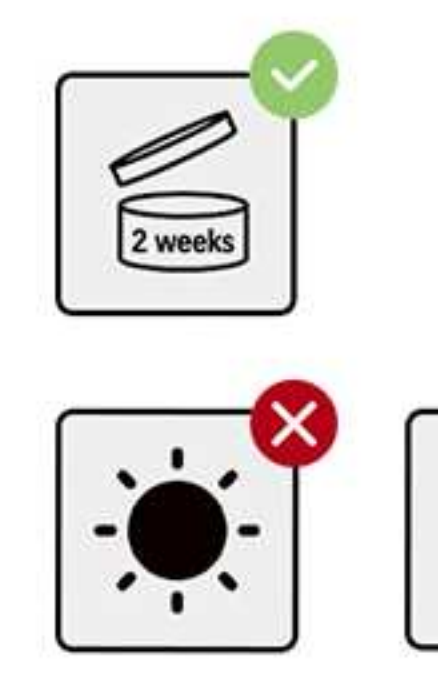
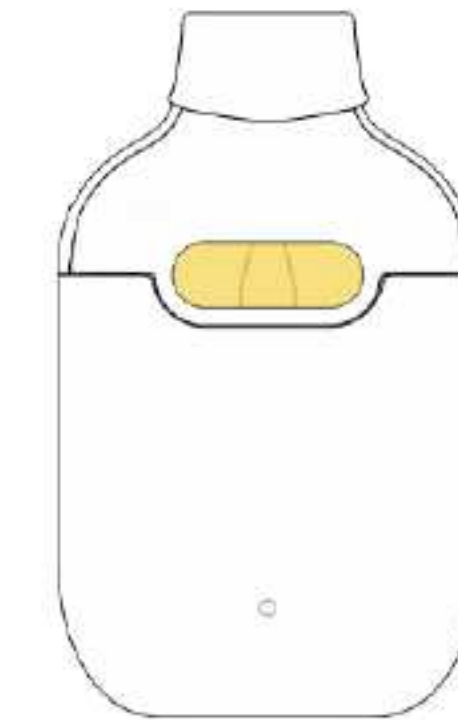

8



- Store the device in a dry, cool place that avoids sunlight.
- After unpacking the product, finish it within 2 weeks for the best taste.



For bulk filling and capping, it is recommended to use specialized tools and jigs to ensure precision. Contact us if needed.

Operating Instructions & Other Functions



| Category | Function | Instruction | LED Indicator | Remarks |
|-----------------|---|---|--|--|
| Operation | Start |  Inhale | Lights Up | The light gradually turns down when stop vaping. |
| | Charging |  Plug in | On: Charging Off: Fully Charged 3 Blinks: Unplugging | |
| Other Functions | Overdose Protection (A puff \geq 10s) | | 2 Blinks | Device stops output after the light blinks. |
| | Low Voltage Protection | | 10 Blinks | Device stops output after the light blinks. |
| | Short-Circuit Protection | | Stays on for 2s | A breakdown occurs. Device stops output. |



<https://ciliconplus.shop>

✉ info@ciliconplus.com

📷 [@cilicon.official](https://www.instagram.com/cilicon.official)

✂ [@CiliconOfficial](https://twitter.com/CiliconOfficial)

📘 [@ciliconofficial](https://www.facebook.com/ciliconofficial)

📌 [@cilicon](https://www.linkedin.com/company/cilicon)
